

KEY PLAN

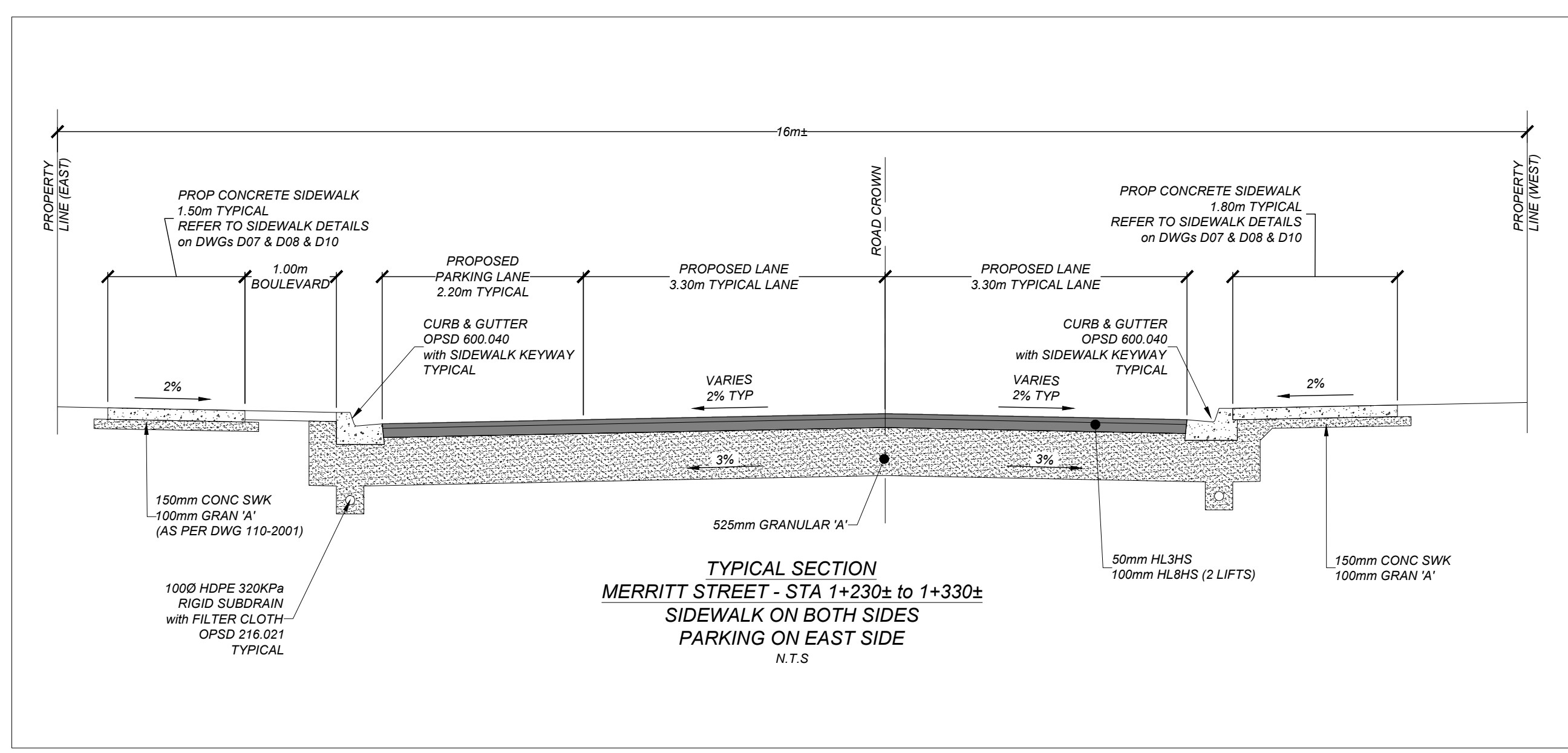

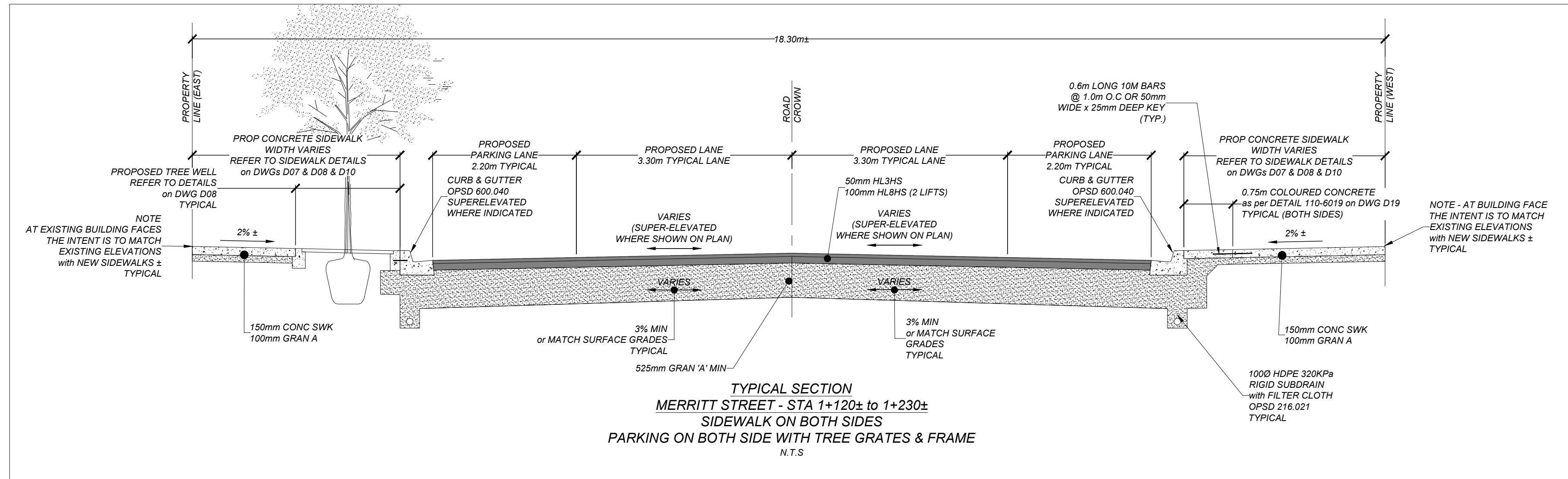

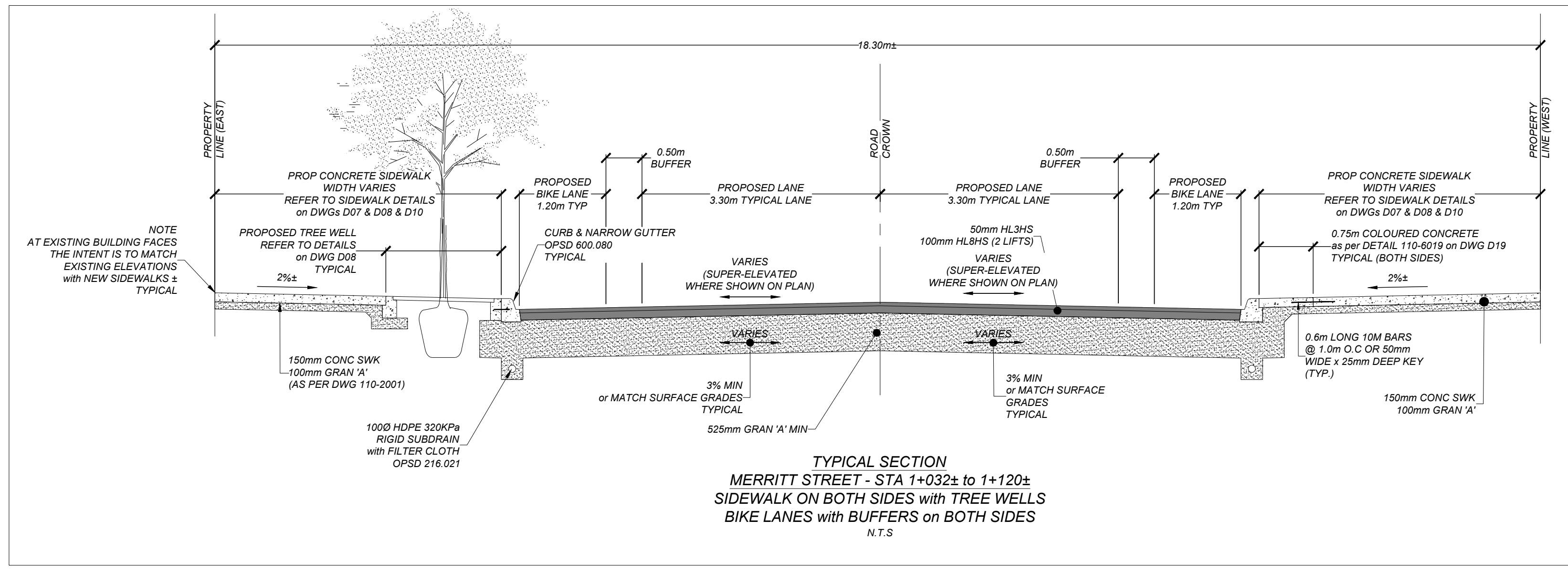
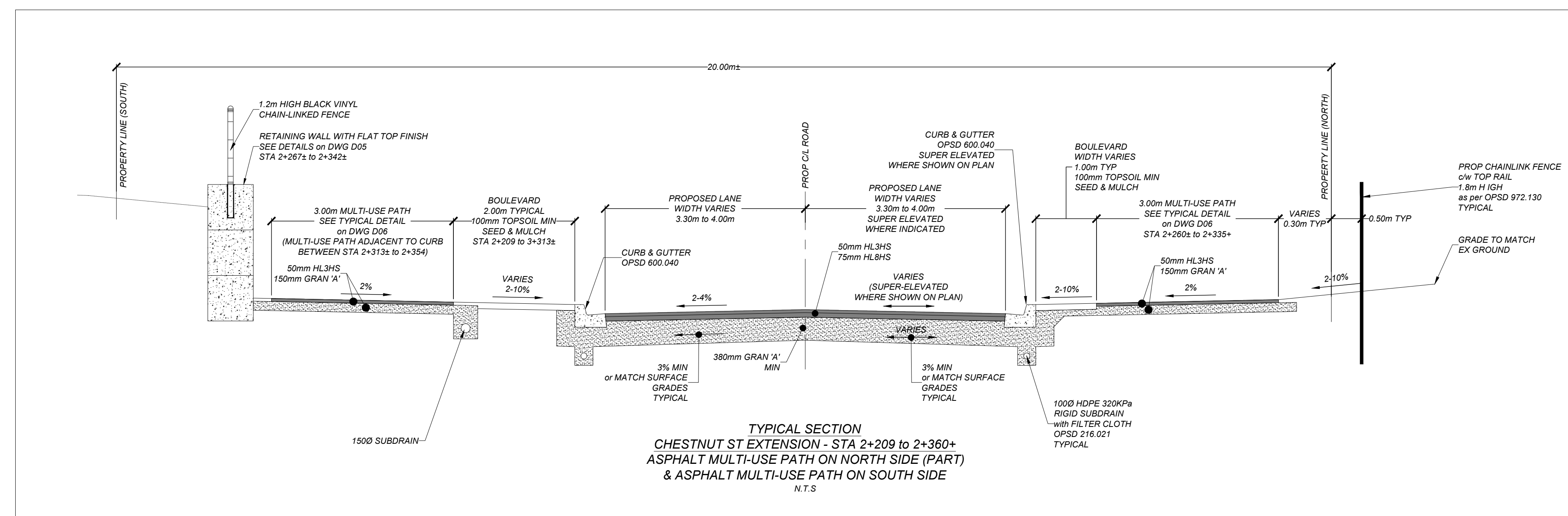
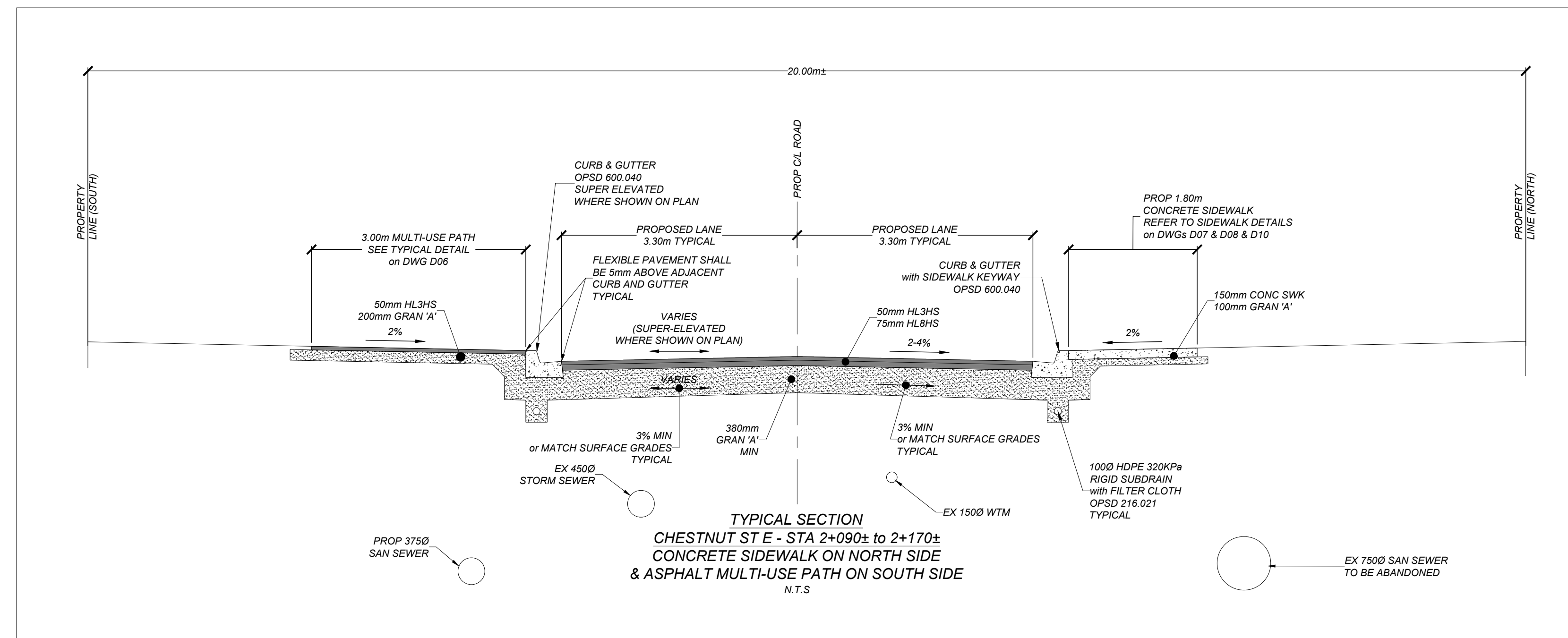
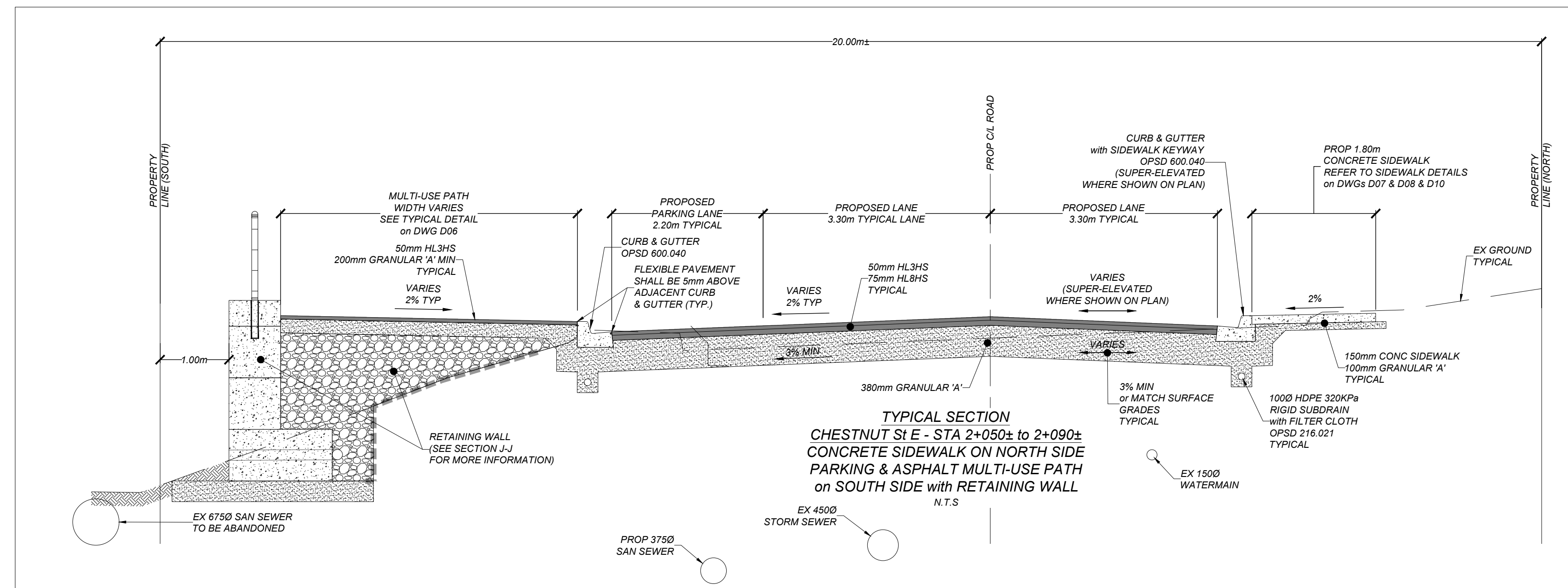
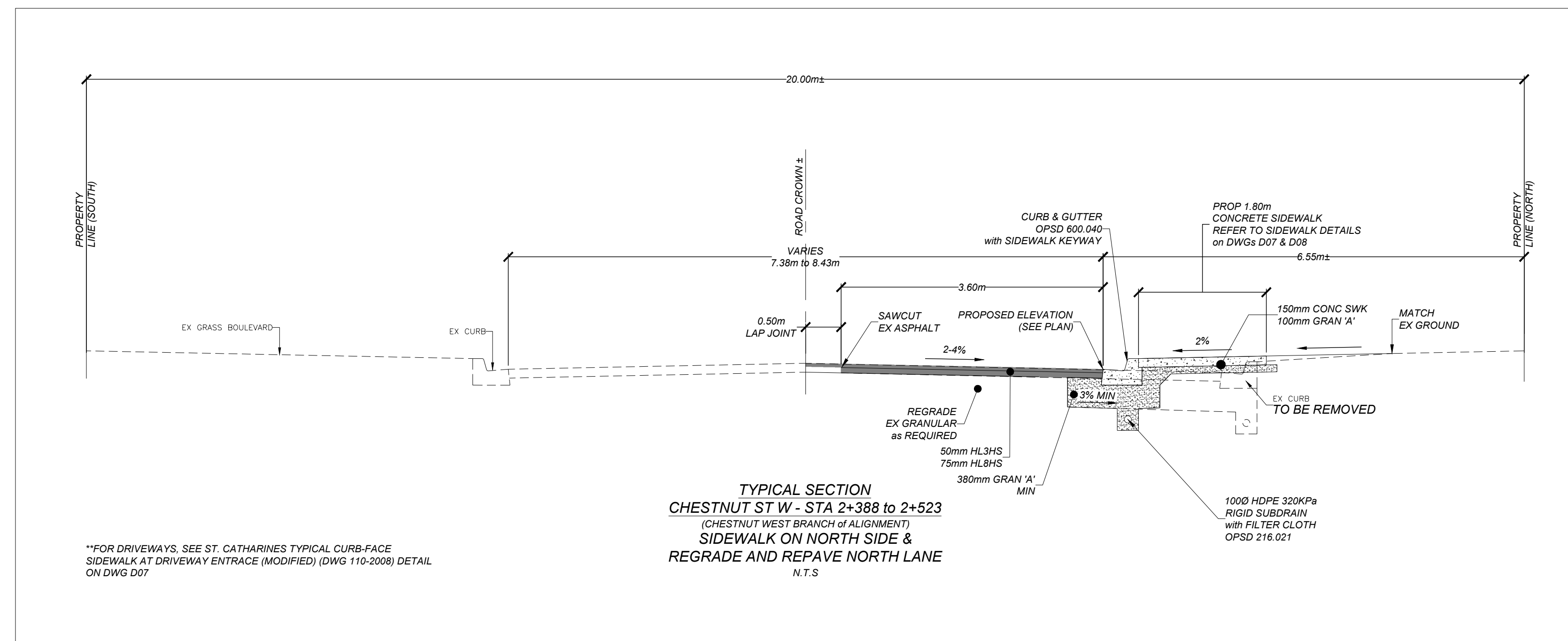
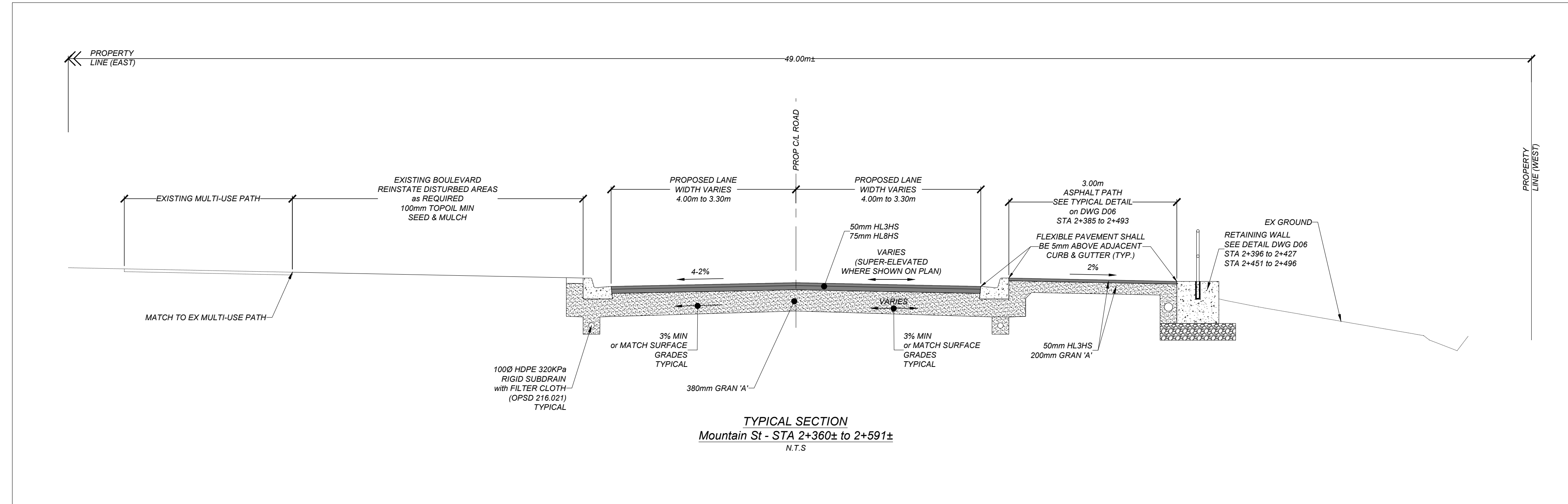

**FOR DRIVEWAYS, SEE ST. CATHARINES TYPICAL CURB-FACE SIDEWALK AT DRIVEWAY ENTRANCE (MODIFIED) (DWG 110-2008) DETAIL ON DWG D07

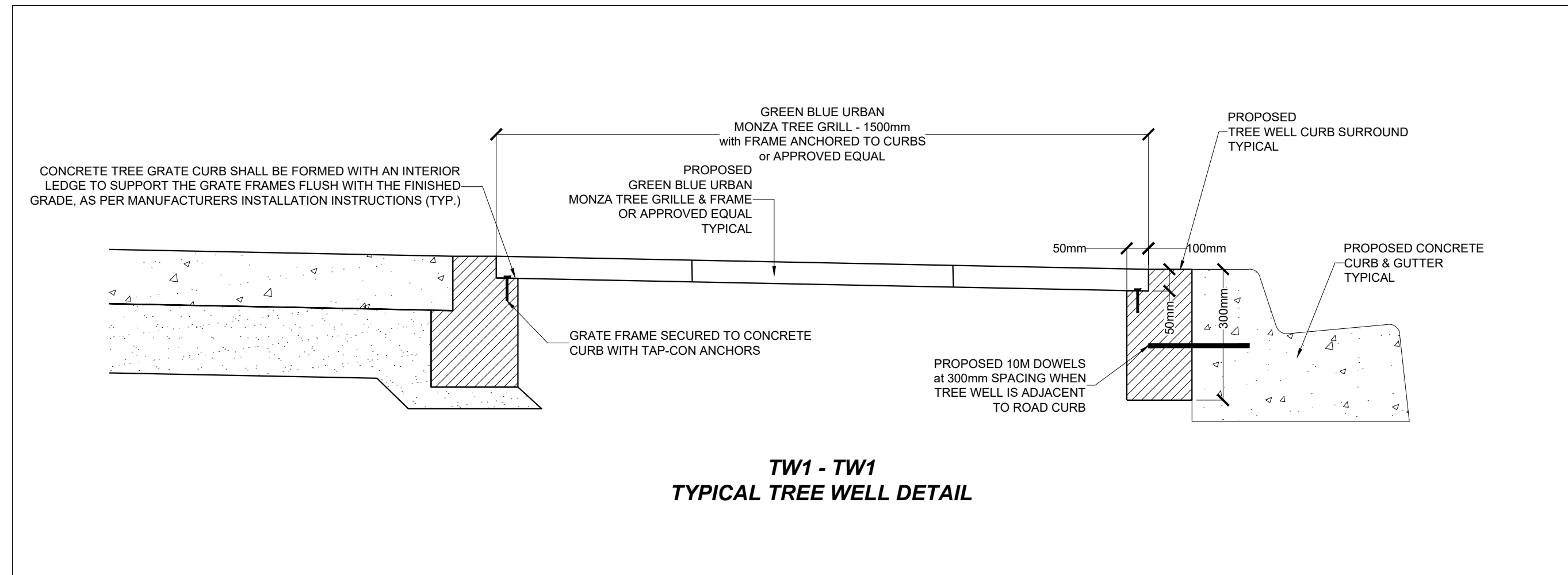
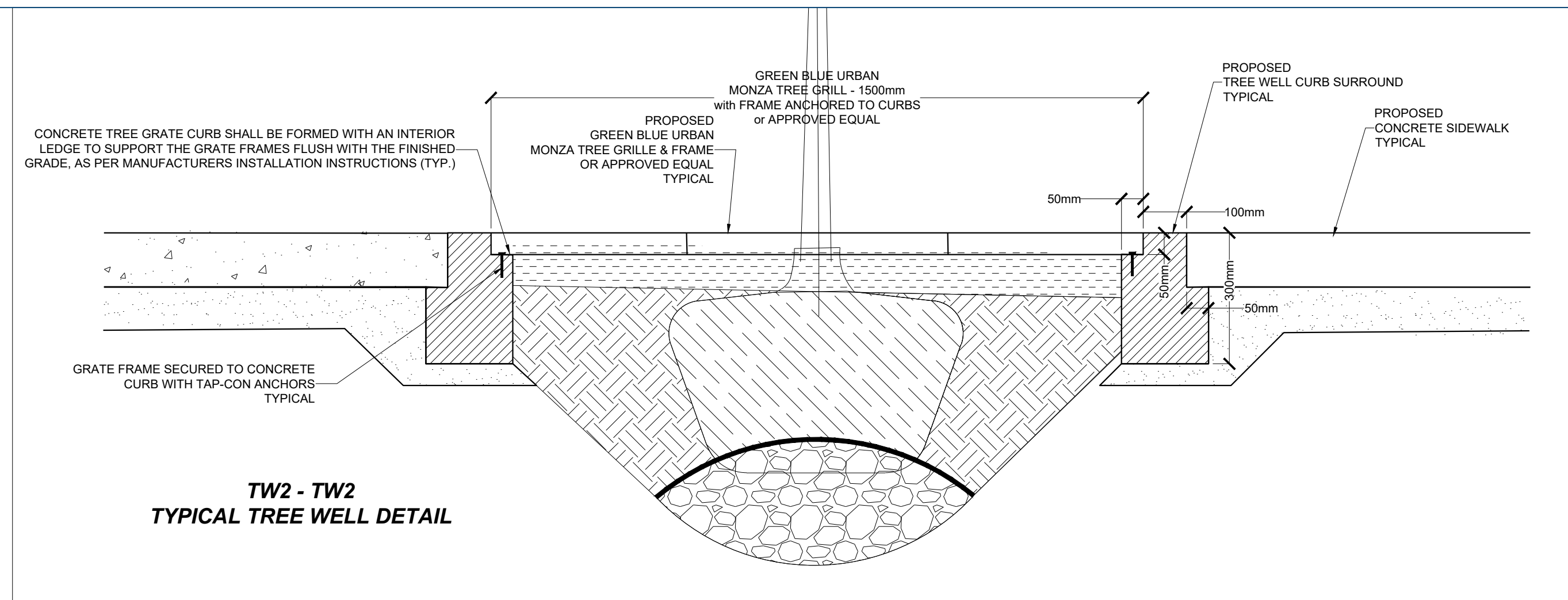
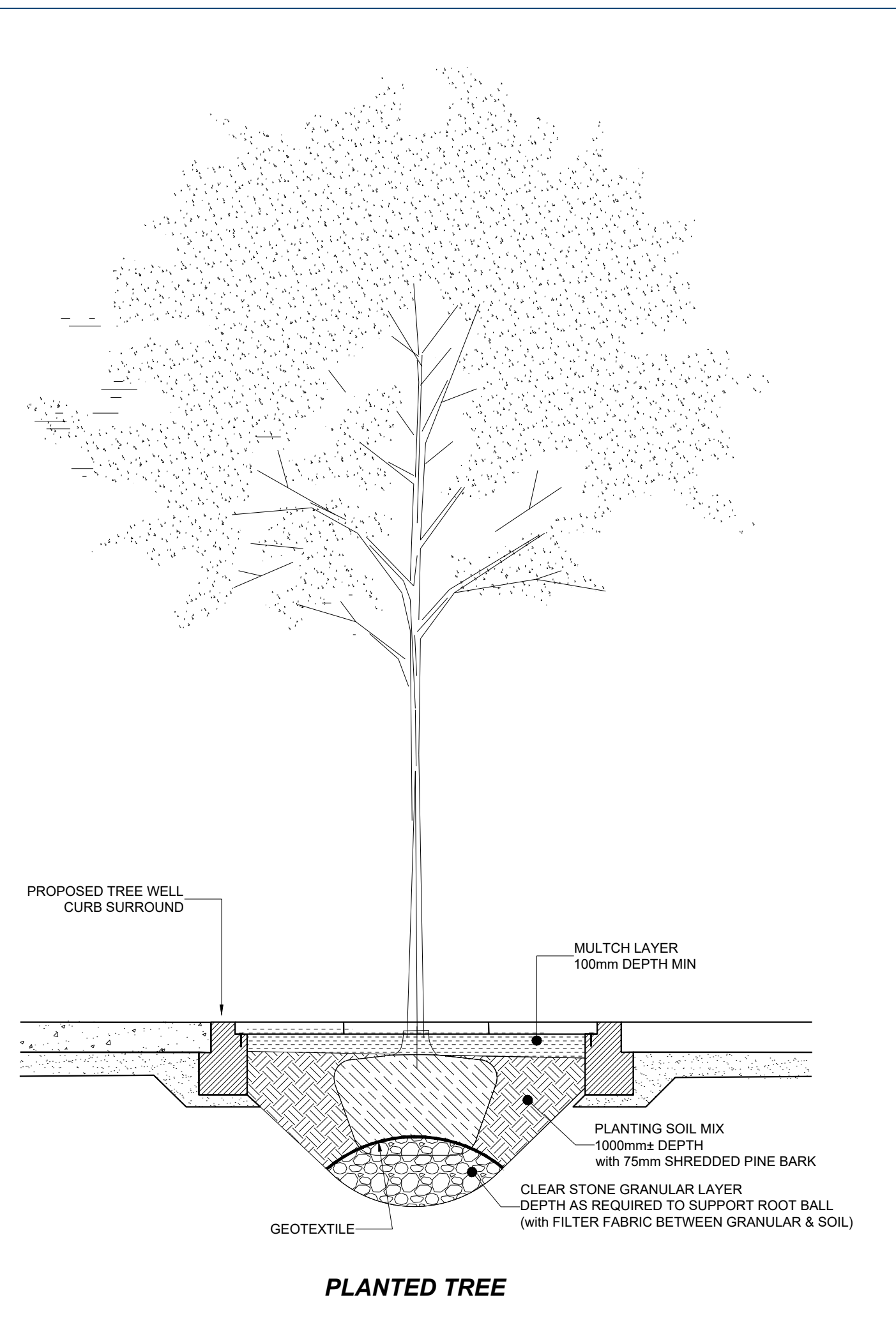

MONZA/THAMES Tree Grille Installation Guide

Monza

Thames

1. Prepare concrete haunch for tree grille as per engineers' drawings
2. Locate both frame halves together on concrete haunch

