

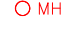









LEGEND

-  - STANDARD IRON BAR
-  - EXISTING MANHOLE
-  - EXISTING CATCH BASIN
-  - EXISTING UTILITY POLE
-  - EXISTING LIGHT POLE
-  - EXISTING SIGN
-  - EXISTING WATER VALVE
-  - EXISTING FIRE HYDRANT VALVE
-  - EXISTING FIRE HYDRANT
-  - EXISTING TREE (TO REMAIN)
-  - NEW 1.5m CONCRETE SIDEWALK
-  - NEW 0.6m GRAVEL SHOULDER

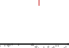

NO.	REVISION	DATE	INIT.
3	ISSUED FOR CONSTRUCTION	JULY 13, 2022	CS
2	ISSUED FOR REVIEW	JULY 5, 2022	CS
1	BASE PLANS	FEB. 2022	AR

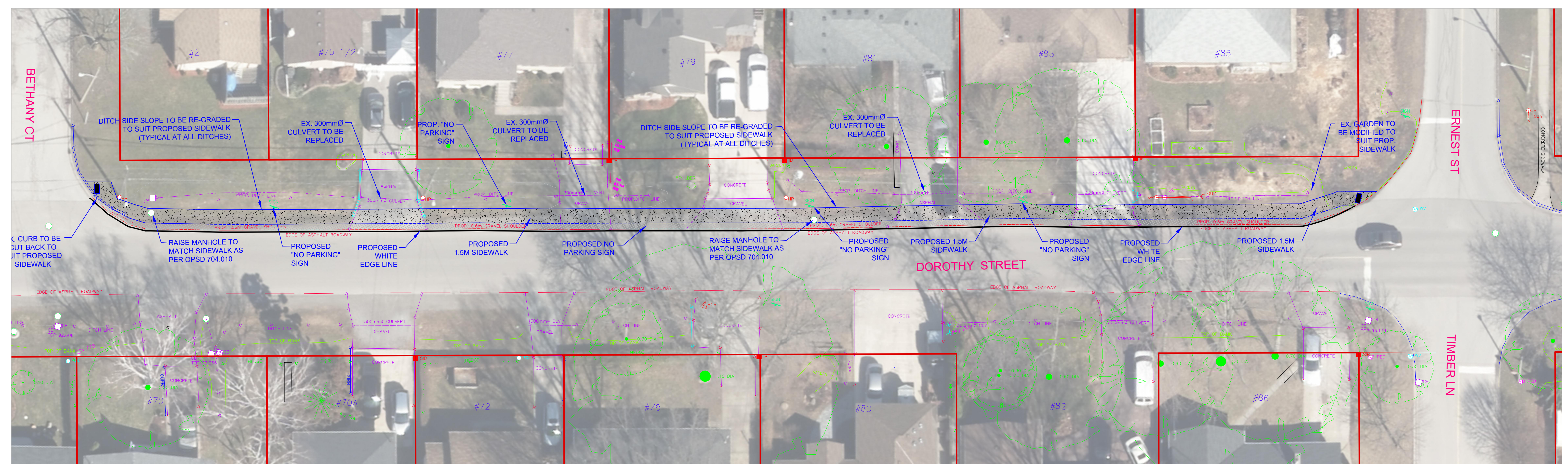
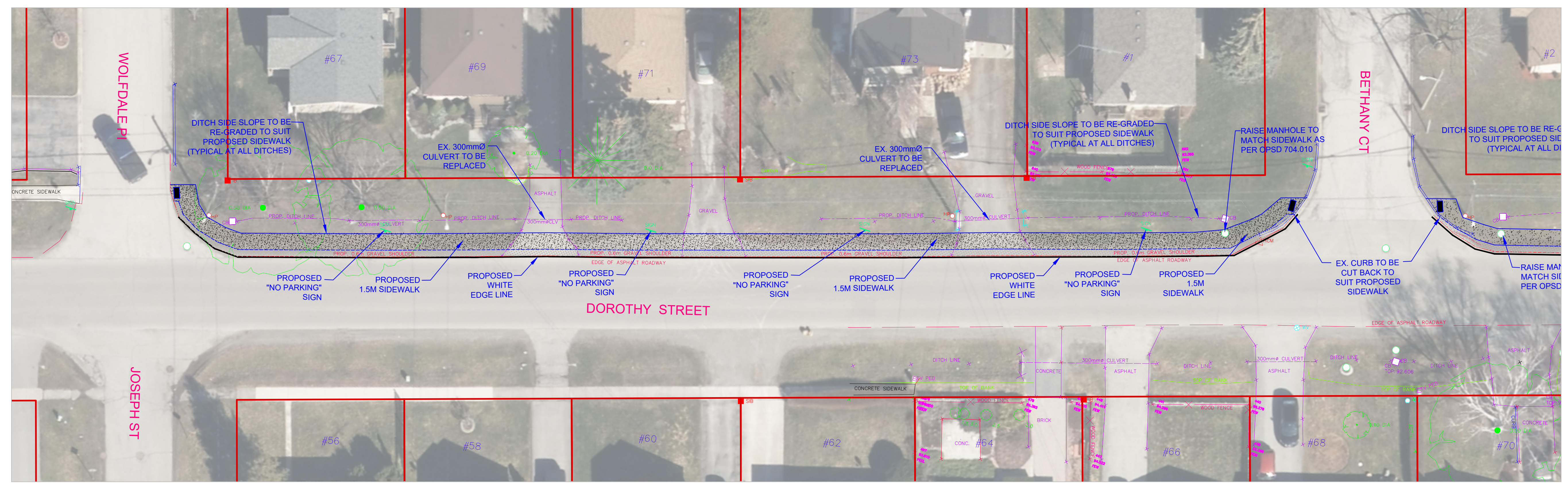
- NOTES**
- THE POSITION OF THE POLE LINES, CONDUITS, WATERMAIN, SEWER AND OTHER UNDERGROUND AND ABOVE-GROUND UTILITIES AND STRUCTURES IS NOT NECESSARILY SHOWN ON THE CONSTRUCTION DRAWINGS AND WHERE SHOWN, THE ACCURACY OF THE POSITION OF SUCH UTILITIES AND STRUCTURES IS NOT GUARANTEED.
 - BEFORE STARTING WORK, THE CONTRACTOR SHALL INFORM HIMSELF OF THE EXACT LOCATION OF SUCH UTILITIES AND STRUCTURES AND SHALL ASSUME ALL LIABILITY FOR DAMAGE TO THEM.
 - HYDRO AND BELL POLES ARE TO BE SUPPORTED AS PER THE RESPECTIVE UTILITY REQUIREMENTS.
 - ALL MANHOLE FRAMES, CATCH BASIN FRAMES, WATER VALVES AND GAS VALVES TO BE ADJUSTED TO FINISH GRADE.
 - ALL PIPE SIZES ARE IN MILLIMETRES UNLESS OTHERWISE NOTED.
 - ALL DIMENSIONS ARE IN METRES UNLESS OTHERWISE NOTED.
 - HIGH PRIORITY FIBRE OPTIC BELL AND COCOCO CABLES ARE PRESENT - USE EXTREME CAUTION.

BASE PLAN	AR	BENCHMARK MONUMENT INSCRIPTION: 9338033
DESIGN	CS	Henley Square Plaza on the northeast corner of Ontario Street and Henley Drive, brass tablet set horizontally in the east face of concrete foundation, 40cm south of the northeast corner, 10cm below brickwork.
CHECKED BY	IA	ELEVATION: 92.965 m

ST. CATHARINES
ENGINEERING, FACILITIES AND
ENVIROMENTAL SERVICES

DOROTHY STREET

PROJECT NUMBER P22-040/041
2022 SIDEWALK PROGRAM
DOROTHY ST. NEW SIDEWALK
NORTH SIDE
WOLFDALE PL. TO ERNEST ST.

FIELD NOTES	100-
DATE	JULY/2022
SCALE	H. 1:200
DWG. No.	C-01
MUN. REF. No.	
REV.	3