

MUSEUM MAP

1

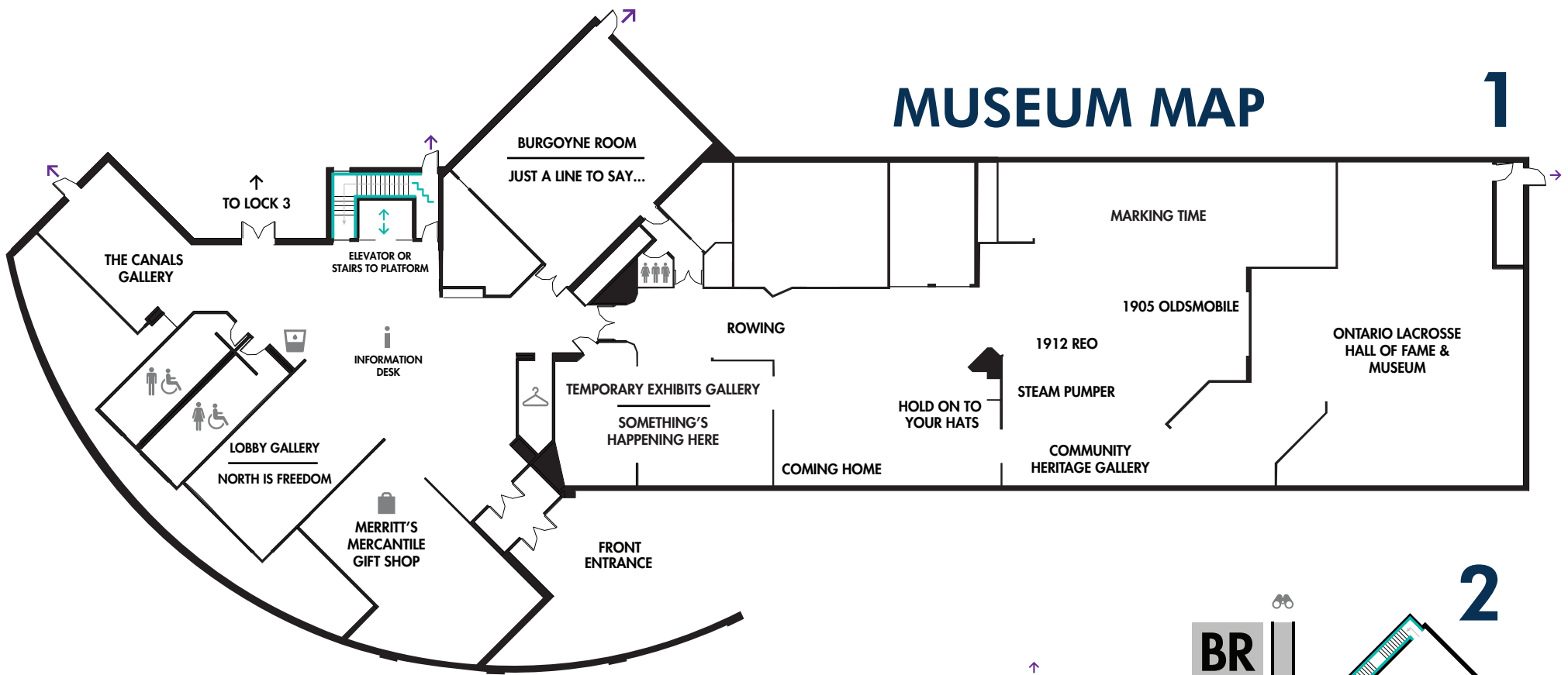

2

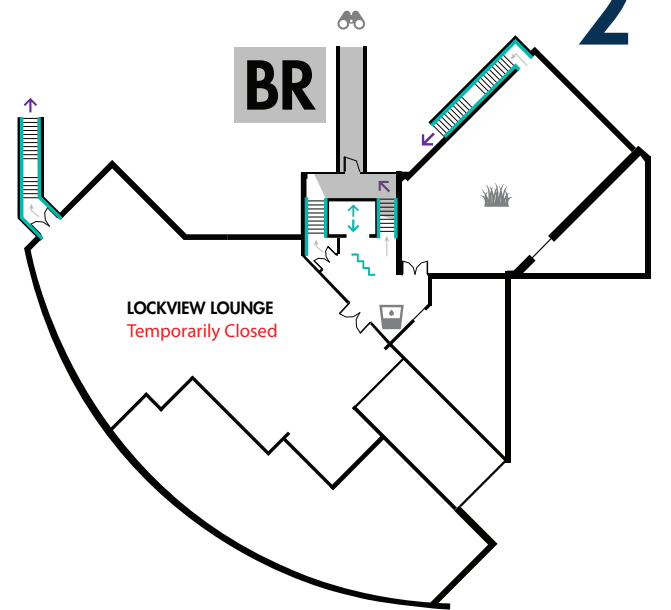

- ELEVATOR
- STAIRCASE
- EMERGENCY EXITS
- INCLUSIVE RESTROOM
- ACCESSIBLE RESTROOM
- INFORMATION DESK
- GIFT SHOP
- COAT ROOM
- WATER FOUNTAIN
- VIEWING PLATFORM
- ROOFTOP GARDEN

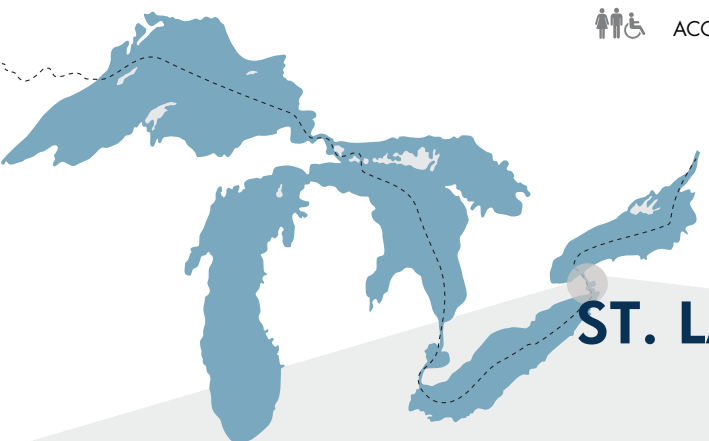

ST. LAWRENCE SEAWAY & THE WELLDAN CANAL

EVOLUTION OF THE WELLDAN CANAL

First Welland Canal
 Known As: *First Welland Canal*
 Built: 1824-1833
 Length: 45km (28 miles)
 Number of Locks: 40 of oak timber
 Length of Locks: 33.5m (110ft)
 Width of Locks: 6.37m (22ft)
 Depth of Locks: 2.4m (8ft)

Second Welland Canal
 Known As: *Old Welland Canal*
 Built: 1842-1853
 Length: 45km (28 miles)
 Number of Locks: 26 of masonry
 Length of Locks: 45.7m (150ft)
 Width of Locks: 8m (26.5ft)
 Depth of Locks: 3.6m (12ft)

Third Welland Canal
 Known As: *New Welland Canal*
 Built: 1872-1887
 Length: 37km (23 miles)
 Number of Locks: 25 of masonry
 Length of Locks: 82.3m (270ft)
 Width of Locks: 13.7m (45ft)
 Depth of Locks: 4.3m (14ft)

Fourth Welland Canal
 Known As: *Welland Ship Canal*
 Built: 1913-1932
 Length: 43.5km (27 miles)
 Number of Locks: 8 of concrete
 Length of Locks: 261.8m (859ft)
 Width of Locks: 24.4m (80ft)
 Depth of Locks: 7.8m (25.5ft)
 Time to Fill 1 Locks: 12 minutes

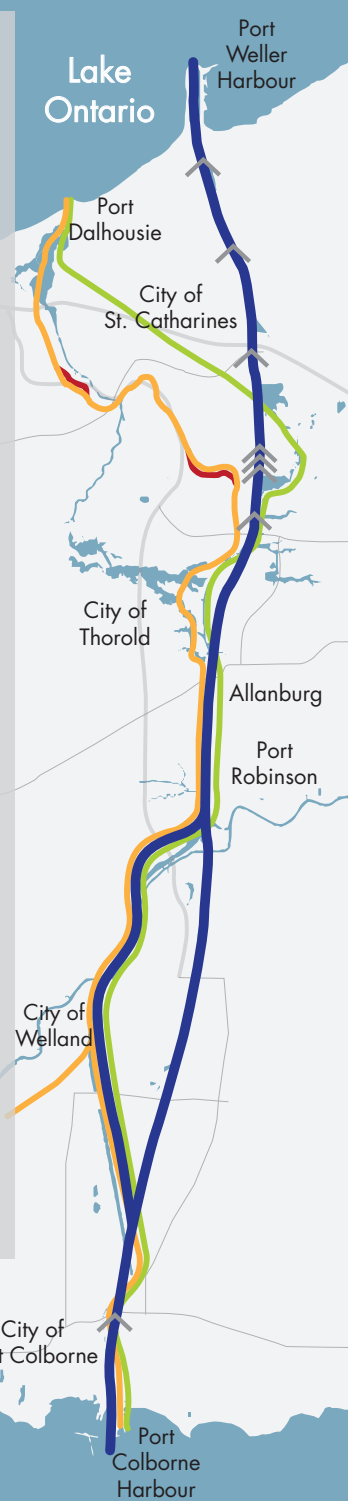

HOW A LOCK WORKS

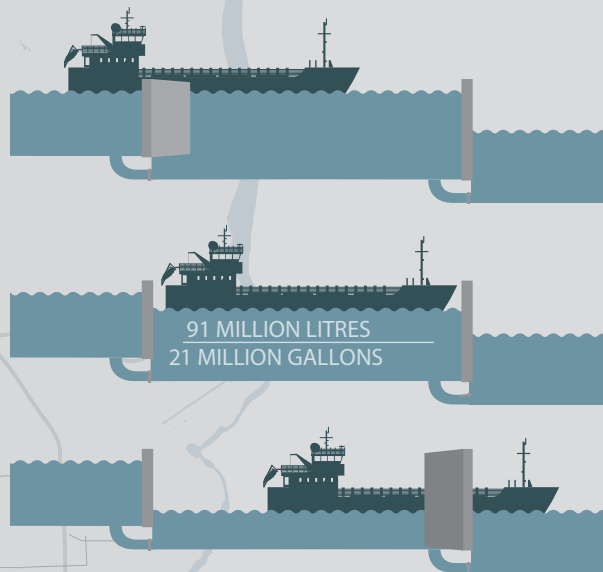

91 MILLION LITRES
 21 MILLION GALLONS

CARGO ON THE CANAL

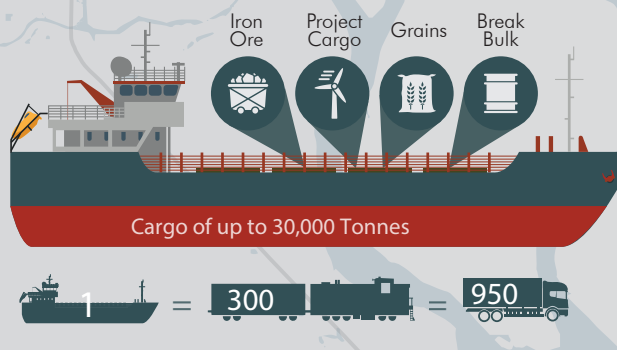

Cargo of up to 30,000 Tonnes

INFORMATION

Passageway for the World

- The Great Lakes comprise the largest and most far-reaching inland waterway in the world (2000km or 1300 miles)
- The Welland Canal allows ships to defy the Falls and conquer the Niagara escarpment in order to continue through the Great Lakes system.

History

- The Welland Canal Company, founded in 1824 by William Hamilton Merritt dug a canal by hand, with only the assistance of horse-drawn carts.
- Today, the canal is operated by the St. Lawrence Seaway Management Corporation

Ships and Cargo

- Tolls for passage vary from \$10,000 to \$31,000 for a loaded cargo ship or barge, depending on gross tonnage, and cargo type. It is approximately \$1,500 for a small passenger ship and \$200 each way for a pleasure craft for all 8 locks.

Bridges and Tunnels

- There are four "swing lift" bridges and three "vertical lift" bridges crossing the Canal while three tunnels pass under the Welland Canal; the Thorold Tunnel, Main Street Tunnel and Townline Tunnel
- All tunnels vary in length due to the canal width above them.

THE GREAT LAKES/ST. LAWRENCE SEAWAY SYSTEM

